

## SUZUKI GSX-R1000/R STREET SPORTS SLIP-ON R-11Sq

Be sure to read the instruction carefully before starting the work. It is necessary to follow the contents to install Yoshimura product.

Product information



- ! CAUTION** Before beginning installation, let motorcycle cool down.
- ! CAUTION** Be sure not to damage each part during installation.
- ! CAUTION** Torque specification must be followed. If neglected, it may cause bolt and nut to fall off and damage to Yoshimura product and motorcycle.
- ! CAUTION** Metal Magic sleeve is coated with heat-resistant paint. Handle with care not to be hit or scratched by surroundings as the coating may come off. When cleaning silencer, use soft cloth with dish soap but do not use metal polish or chemical cleaner.
- ! CAUTION** Titanium Blue sleeve is colored by anodizing. Handle with care as the color may change. When cleaning silencer, use soft cloth with dish soap but do not use metal polish or chemical cleaner.

### 1. Product Information :

Description	SUZUKI GSX-R1000/R Street Sports Slip-On R-11Sq	Cyclone Type	S50AS1QC2
Part Number	Stainless Sleeve (SS) : 180-50A-L15G2	Main Material	Stainless steel
	Metal Magic Sleeve (SM) : 180-50A-L12G2	Weight [STD : 3.8kg]	(SS) & (SM) : 2.7kg
	Titanium Sleeve (ST) : 180-50A-L18G2		(ST) & (STB) : 2.5kg
	Titanium Blue Sleeve (STB) : 180-50A-L16G2		

### 2. Applicable Model :

Model	SUZUKI GSX-R1000/R ('17-'22)
-------	------------------------------

### 3. Contents:

No.	Descriptions	Part No.	Q'ty	No.	Descriptions	Part No.	Q'ty
1	Tailpipe	185-50A-L100	1	4	Washer M8x26	812-108-2600	1
2	Silencer Assy Stainless Sleeve	186-50A-L15G0	1	5	Button Bolt M6x20	803-206-4020	2
	Silencer Assy Metal Magic Sleeve	186-50A-L12G0		6	Washer M6x13	812-206-1310	2
	Silencer Assy Titanium Sleeve	186-50A-L18G0		7	Flange Nut M6	823-006-1000	2
	Silencer Assy Titanium Blue Sleeve	186-50A-L16G0		8	Exhaust Spring	118-001-0000	1
3	Silencer Bracket	161-50A-0230	1	9	Clamp Band	162-02215559	1

### 4. Optional Part :

Description	Part No.
Optional Exhaust Pipe	194-50A-0010
Silencer Bracket Set	194-50A-0020
Carbon Heat Guard Set	194-50A-0030

### Parts Diagram

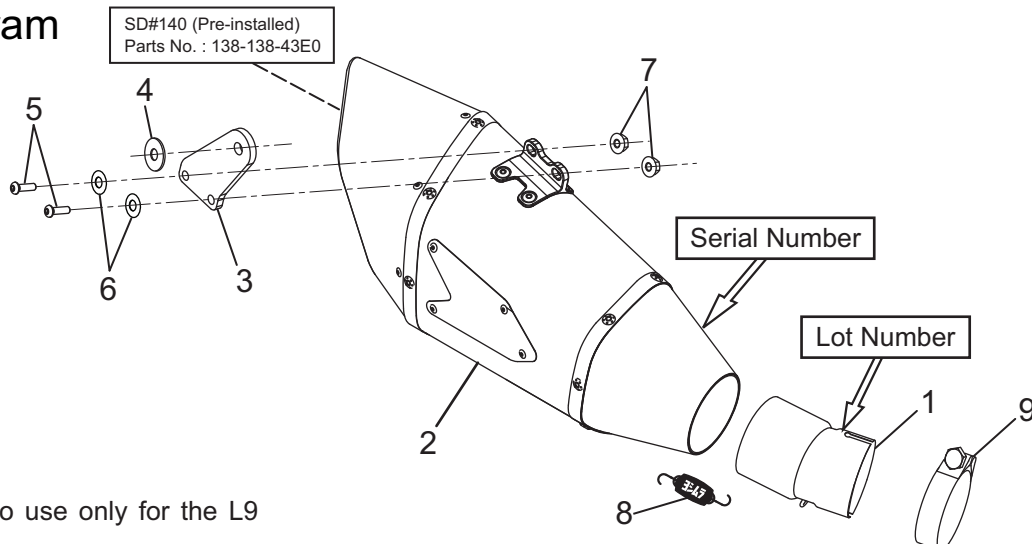

No. 9 is required to use only for the L9 and later models.